

Design Group G

Group **G**, dry product metering devices are designed for accurate metering of dry powders and granular material with discharge capacities of up to 1420 kg/h/3130 lbs/h at a powder density of 1.0.

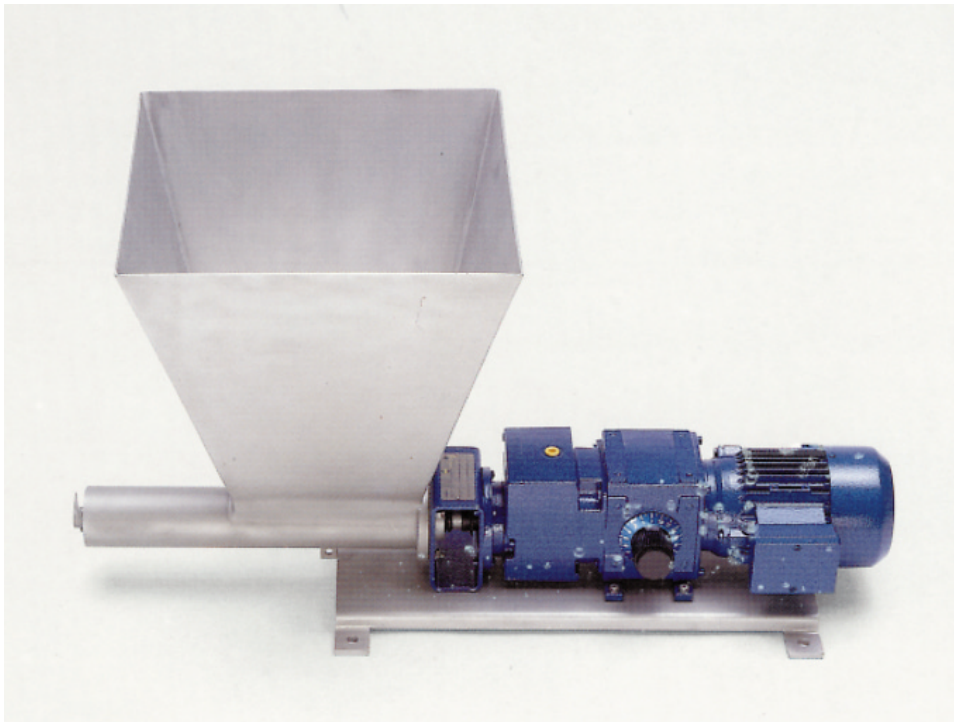

Dry product metering device range DG



seepex range DG devices are used for the accurate, constant metering of powders and granular material.

Relevant applications include the dosing of lime and other dry chemicals in water and waste water processing, as well as a number of applications in the chemical, food and synthetic fiber or plastics industry.

seepex dry product metering devices have a large feed hopper, where the compact feed screw rotates at the bottom with a fine tolerance between the casing and screw. The compact feed screw transports the product to the metering mouth piece. At the end of the compact feed screw there is a stripping device, which prevents the product from settling at the outlet and enlarges the product spray field.

The metering mouth piece can also be equipped with a heater, which can easily be added in the field. This heater is recommended when transporting products which are susceptible to packing, in high humidity installations.

Special Feature and Technical Advantages

- ~ trouble-free transportation of all free flowing products up to 2.0 density
- ~ constant supply with high accuracy $\pm 3\%$
- ~ dosed feed level for constant regulated feed
- ~ optimum emptying by way of a screw with a fine tolerance between screw and casing
- ~ no entry of humidity when using a closed system
- ~ compact design
- ~ easy exchange of the feed screw
- ~ gentle treatment of the product
- ~ long service life
- ~ sealing by means of a labyrinth ring

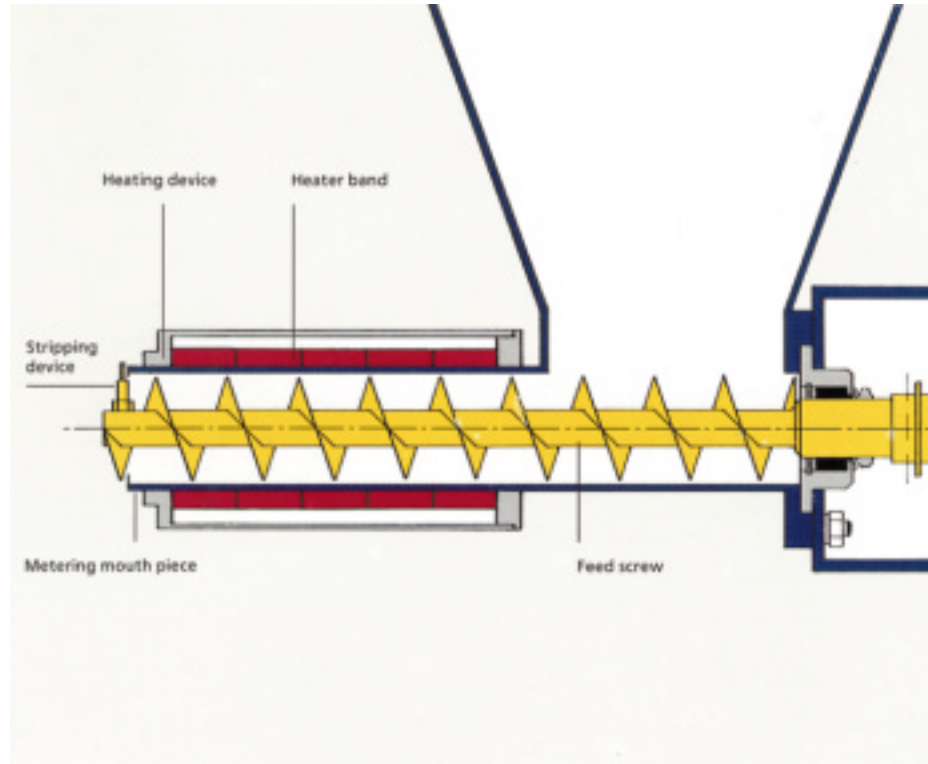

Dimensions in mm

Size	045-30	062-60
A	400	400
B	400	400
F*	120	120
H	450	450
K	360	475
O	238	298
A1	420	510
B1	240	240
F1	280	280
L	460	550
S	13	13
P	130	130
Weight in kg	17	18
Hopper volume in liter approx.	30	35

*For a drive with flange B5, diameter 120 mm

Available in the materials

1.0037 (St 37-2)

1.4301/AISI 304 ground internally,
glass bead blown externally

1.4571/AISI 316 ground internally,
glass bead blown externally

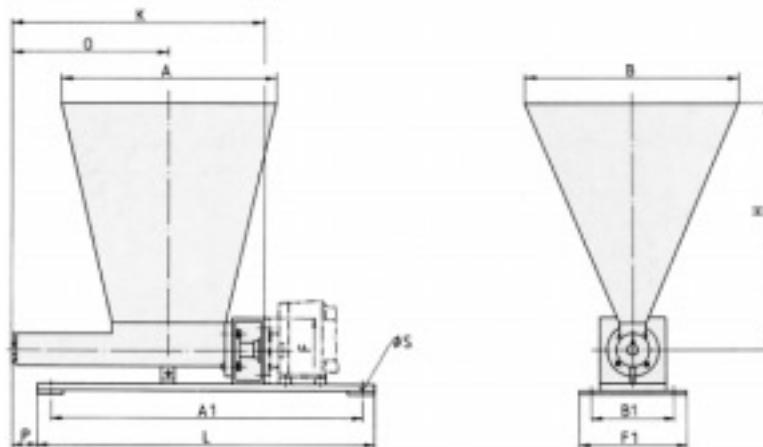

Drive

Kind of drive	Frictional variable speed foot/flange mounted B3/B5 Output flange 120 mm Range R=80
Motor capacity/ speed at 50 Hz	0.25 kW/1380 rpm
Available output speeds at 50 Hz	1.07 - 86 rpm 1.54 - 124 rpm 1.90 - 152 rpm
H1	60 mm
H2	196 mm
K2	450 mm
Weight in kg	18.5

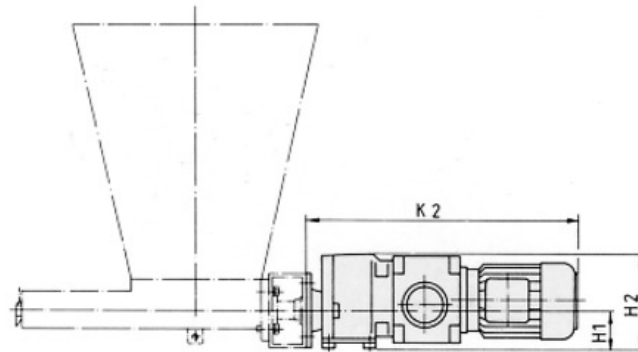

Conveying capacities

	Y(kg/dm ³)	
Theoretical volumetric conveying capacity	1.00	—————
Polymer	0.80	—————
slaked lime	0.62	- - - - -
Size		
045-30	062-60	

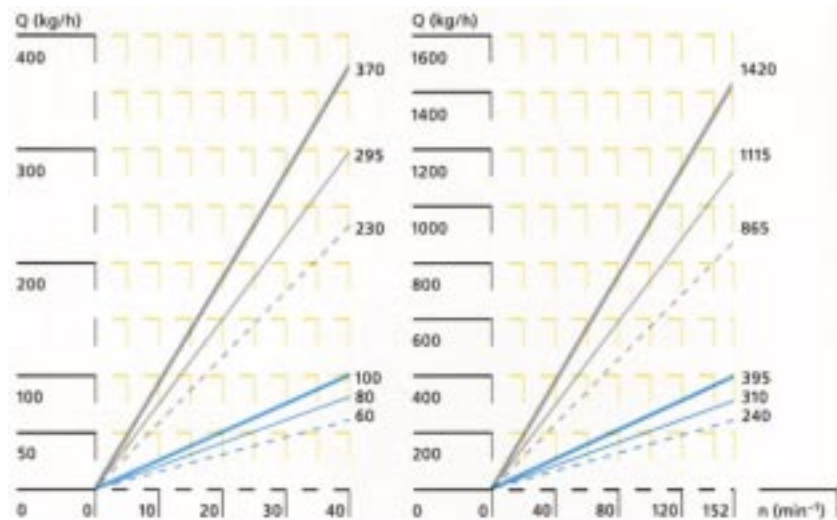

All indications concerning dimensions and weight are non-binding and are subject to modification.

For the complete delivery program see publication 600.