

Design Group CS

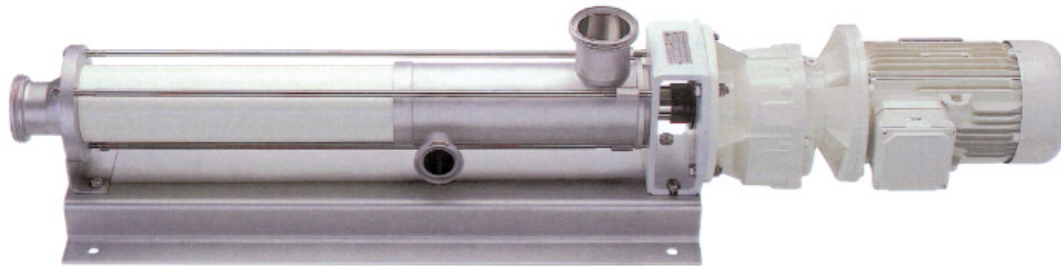

Group CS pumps are designed for universal use in the food, pharmaceutical, cosmetic and chemical industries.



Design of group CS

seepex pumps of groups **CS** are designed for universal use in the food, pharmaceutical, cosmetic and chemical industries. These pumps meet the highest standards for gentle handling, sanitation, cleaning and sterilization in place.

Advantages of **seepex** pumps group **CS**:

- Streamlined, “dead zone free” pump casings avoid product build-up.
- Polished finish of wetted casing walls and rotating parts simplify CIP.
- New, easily replaces joint components reduce service time and cost.
- Proven mechanical seals, selected for the application conditions, ensure product integrity.
- A wide selection of elastomers which meet FDA standards, ensure product integrity and compatibility.
- CIP (Cleaning In Place) with high flow rates inside the pump casing ensures positive cleaning.
- SIP (Sterilization In Place) with high-temperature steam is possible if the pump is cycle operated.
- Pumps of group **CS** are authorized by the 3-A Sanitary Symbol Counsel.

Range BCSO



Click to magnify



Click to demagnify



Use hand to navigate

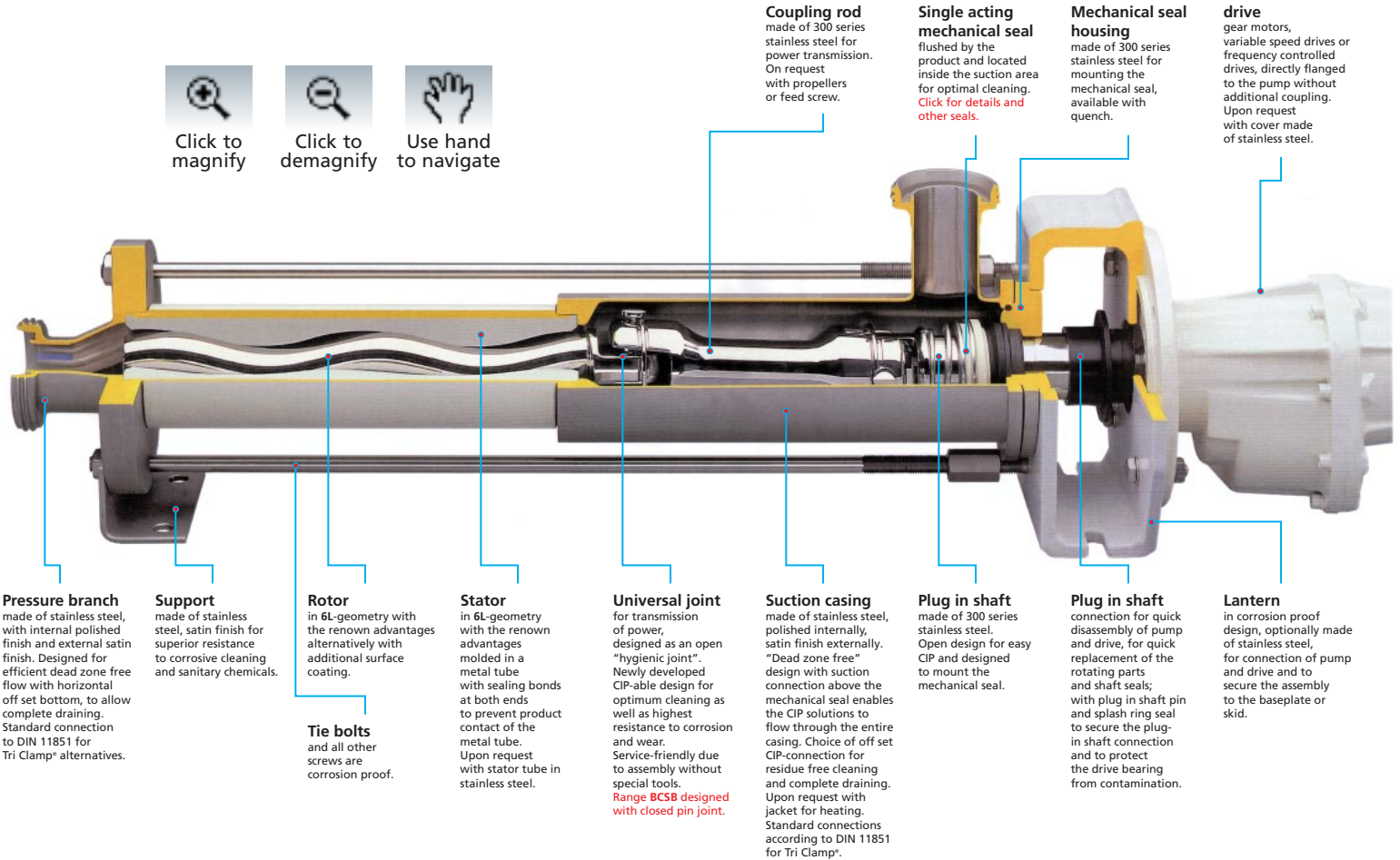

Pressure branch
made of stainless steel, with internal polished finish and external satin finish. Designed for efficient dead zone free flow with horizontal off set bottom, to allow complete draining. Standard connection to DIN 11851 for Tri Clamp® alternatives.

Support
made of stainless steel, satin finish for superior resistance to corrosive cleaning and sanitary chemicals.

Rotor
in 6L-geometry with the renowned advantages alternatively with additional surface coating.

Tie bolts
and all other screws are corrosion proof.

Stator
in 6L-geometry with the renowned advantages molded in a metal tube with sealing bonds at both ends to prevent product contact of the metal tube. Upon request with stator tube in stainless steel.

Universal joint
for transmission of power, designed as an open "hygienic joint". Newly developed CIP-able design for optimum cleaning as well as highest resistance to corrosion and wear. Service-friendly due to assembly without special tools. **Range BCSB designed with closed pin joint.**

Suction casing
made of stainless steel, polished internally, satin finish externally. "Dead zone free" design with suction connection above the mechanical seal enables the CIP solutions to flow through the entire casing. Choice of off set CIP-connection for residue free cleaning and complete draining. Upon request with jacket for heating. Standard connections according to DIN 11851 for Tri Clamp®.

Coupling rod
made of 300 series stainless steel for power transmission. On request with propellers or feed screw.

Single acting mechanical seal
flushed by the product and located inside the suction area for optimal cleaning. **Click for details and other seals.**

Plug in shaft
made of 300 series stainless steel. Open design for easy CIP and designed to mount the mechanical seal.

Mechanical seal housing
made of 300 series stainless steel for mounting the mechanical seal, available with quench.

Plug in shaft
connection for quick disassembly of pump and drive, for quick replacement of the rotating parts and shaft seals; with plug in shaft pin and splash ring seal to secure the plug-in shaft connection and to protect the drive bearing from contamination.

drive
gear motors, variable speed drives or frequency controlled drives, directly flanged to the pump without additional coupling. Upon request with cover made of stainless steel.

Lantern
in corrosion proof design, optionally made of stainless steel, for connection of pump and drive and to secure the assembly to the baseplate or skid.



Summary of Ranges

Range BCSO

The pumps of range **BCSO** are equipped with open "hygienic" universal joints that have been newly developed. With CIP flushing, a residue-free cleaning is ensured. They fulfill the highest demands for hygienic cleaning and resistance to corrosion and wear.

Beside the special design of coupling rod and rotor or plug-in shaft end, the new universal joint consists of only two components, the pin and the circlip. Service work can be performed easily and quickly without tools. Meet the specifications of the 3A-Sanitary Standards of the U.S.

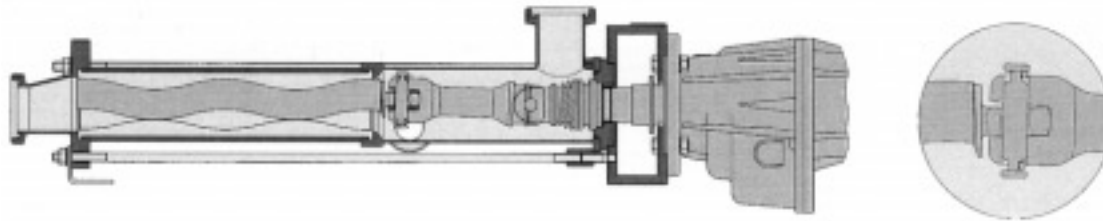

Summary of Ranges *(continued)*

Range BCSB

The pumps of range **BCSB** differ from range BCSO only by the universal joint design. For range **BCSB**, the proven closed pin joints used for the seepex pumps of ranges **BN/NS** are installed. The cost-saving pin joints are filled with a special food-grade grease.

Also, they are closely sealed by elastic universal joint sleeves and metal holding bands. They are particularly suitable for highly abrasive liquids and very high operating pressures.

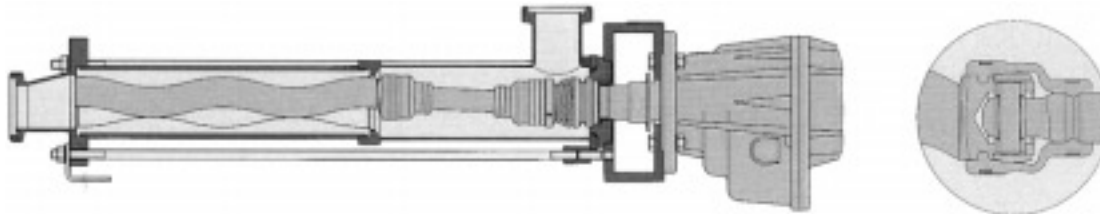

Summary of Ranges *(continued)*

Range BTCS

Range **BTCS** uses an inlet hopper with a cylindrical compression zone. Products with a poor flowability are fed via the auger feed screw on the coupling rod to the rotor and stator.

Optimal filling of the conveying cavities is achieved by the action of the auger in the compression zone. Generally, BTCS pumps are equipped with the open and service-friendly universal joints.

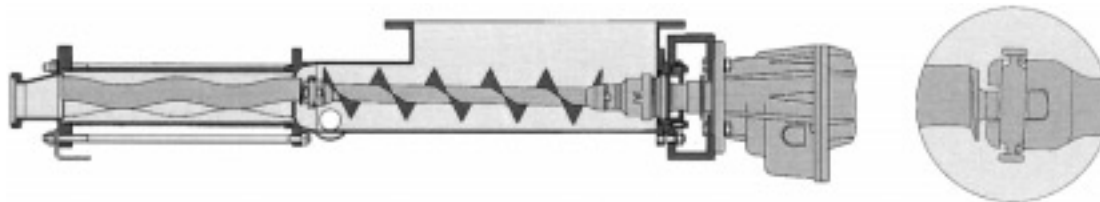

Design Variants

CIP connection

to flush the suction with high velocity cleaning liquids for complete cleaning as well as draining by an off set arrangement of the CIP branch.

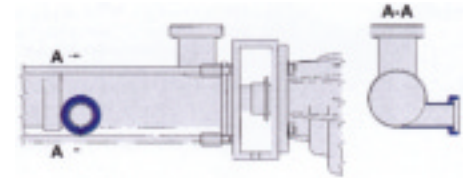

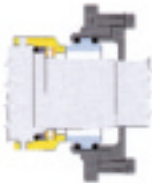

mechanical seals

Design	Code	Products	pressure admissible at the shaft seal	Remarks	Used in pump range	
single-acting, conical spring, dependent of direction of rotation, unbalanced	G60	medium viscosities, low solids	-0.15 up to +25 bar (-2 to +370 psi)	economical standard seal for food, beverage and pharmaceutical industries	BCSO	
single-acting, double 'O' ring mounted stationary seat, wave spring independent of direction of rotation, balanced	G61	high viscosities, with high solids adhesive abrasive	-0.15 up to +16 bar (-2 to +210 psi)	mechanical seal for products which are difficult to seal in the food and pharmaceutical industries	BCSO BTCS	

Design Variants *(continued)*

mechanical seals

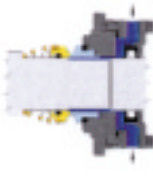
Design	Code	Products	pressure admissible at the shaft seal	Remarks	Used in pump range	
single-acting, elastomer bellows, independent of direction of rotation, unbalanced	GA	high viscosities, high solids, abrasive	-0.5 up to +12 bar (-7 to +90 psi)	seals which is resistant to wear for the fiber and chemical industries	BCSB	
single-acting, conical spring, dependent of rotation, balanced	GB	medium viscosities, low solids	-0.5 up to +25 bar (-7 to +370 psi)	economical standard seal for the food, beverage and pharmaceutical industries	BCSB	
mechanical seal with quench for designs G60 to GB	...M	crystallizing adhesive	acc. to the information given in G60 to GB vacuum upto -0.5 bar (-7 psi)	unpressurized quench supply filled with appropriate liquid for lubrication when a vacuum exists or when pump is installed in vertical position	BCSO BCSB BTCS	

Dimensions

Range BCSO/BCSB

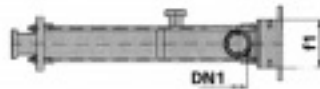
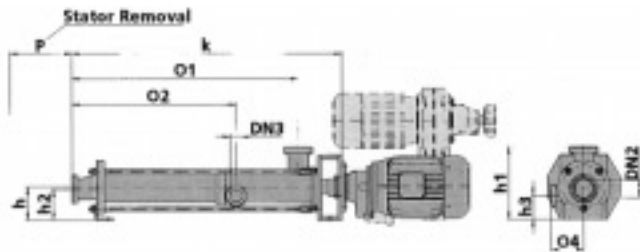

Drive Options
Mechanical variable Speed
Gear Motor

Range BTCS

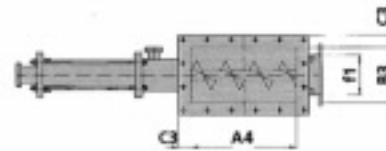
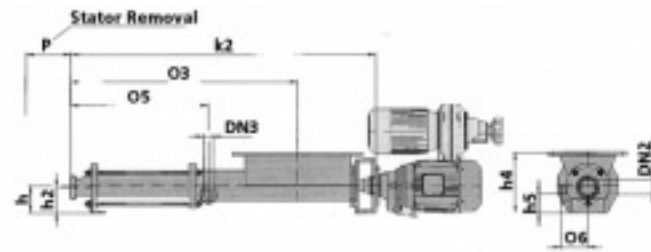

Drive Options
Mechanical variable Speed
Gear Motor

Dimensions *(continued)*



pump model																					Section Fitting		Discharge Fitting		CIP-Fitting		Net Wt. approx. (kg)	
	f1	h	h1	h2	h3	h4	h5	k	k2	O1	O2	O3	O4	O5	O6	P	A4	B3	C3	1) DN 1	2) DN 1	1) DN 2	2) DN 2	1) DN 3	2) DN 3	Design BCSO	BTCS	
																					1)	2)	1)	2)	1)	2)	BCSB	BTCS
025-12	100	70	160	67	47	180	45	489	666	401	269	488	75	273	70	155	230	140	30	25	1"	25	1"	20	3/4"	9	17	
5-12	100	70	160	66	50	180	47	529	706	438	313	528	75	318	70	195	230	140	30	32	1 1/2"	32	1 1/2"	25	1"	10	18	
1-6L	100	70	160	66	50	180	47	529	706	438	313	528	75	318	70	195	230	140	30	32	1 1/2"	32	1 1/2"	25	1"	10	18	
1-6	130	90	200	83	63	210	61	535	699	421	243	491	90	251	85	135	250	145	40	40	1 1/2"	40	1 1/2"	25	1"	17	28	
1-12	130	90	200	83	63	210	61	661	825	547	369	617	90	377	85	255	250	145	40	40	1 1/2"	40	1 1/2"	25	1"	19	30	
2-6L	130	90	200	83	63	210	61	661	825	547	369	617	90	377	85	255	250	145	40	40	1 1/2"	40	1 1/2"	25	1"	19	30	
2-6	130	90	200	84	66	210	58	579	853	459	289	595	90	305	90	170	350	180	40	50	2"	50	2"	32	1 1/2"	18	29	
2-12	130	90	200	84	66	210	58	739	1013	619	449	755	90	465	90	325	350	180	40	50	2"	50	2"	32	1 1/2"	21	33	
5-6L	130	90	200	84	66	210	58	739	1013	619	449	755	90	325	90	325	350	180	40	50	2"	50	2"	32	1 1/2"	21	33	
5-6	140	100	225	93	69	230	66	694	983	552	347	711	105	215	105	215	350	220	40	65	2 1/2"	65	2 1/2"	40	1 1/2"	25	38	
5-12	140	100	225	93	69	230	66	894	1183	752	547	911	105	410	105	410	350	220	40	65	2 1/2"	65	2 1/2"	40	1 1/2"	31	46	
10-6L	140	100	225	93	69	230	66	894	1183	752	547	911	105	556	105	410	350	220	40	65	2 1/2"	65	2 1/2"	40	1 1/2"	31	46	
10-6	155	125	275	116	88	270	83	840	1227	681	421	870	115	432	115	295	500	240	50	80	3"	80	3"	50	2"	41	54	
10-12	155	125	275	116	88	270	83	1092	1479	933	673	1122	115	684	115	520	500	240	50	80	3"	80	3"	50	2"	60	69	
15-6LT	140	100	225	93	69	230	66	894	1183	752	547	911	105	556	105	410	350	220	40	65	2 1/2"	65	2 1/2"	40	1 1/2"	31	46	
17-6L	155	125	275	116	88	270	83	1092	1479	933	673	1122	115	685	115	520	500	240	50	80	3"	80	3"	50	2"	60	69	
17-6	180	140	310	130	98	310	87	979	1496	809	494	1063	135	523	135	335	650	280	50	100	4"	100	4"	65	2 1/2"	70	100	
17-12	180	140	310	130	98	310	87	1285	1802	1115	800	1369	135	829	135	645	650	280	50	100	4"	100	4"	65	2 1/2"	83	120	
26-12	180	140	310	121	98	310	87	1393	1916	1223	903	1477	150	937	135	765	650	280	50	100	4"	100	4"	65	2 1/2"	105	135	
30-6LT	155	125	275	116	88	270	83	1092	1479	933	673	1122	115	685	115	520	500	240	50	80	3"	80	3"	50	2"	60	69	
35-6L	180	140	310	130	98	310	87	1285	1802	1115	800	1369	135	829	135	645	650	280	50	100	4"	100	4"	65	2 1/2"	83	120	
52-6L	180	140	310	121	98	310	87	1393	1910	1223	903	1477	150	937	135	765	650	280	50	100	4"	100	4"	65	2 1/2"	105	135	
55-6LT	180	140	310	130	98	310	87	1285	1802	1115	800	1369	135	829	135	645	650	280	50	100	4"	100	4"	65	2 1/2"	83	120	
75-16LT	180	140	310	121	98	310	87	1393	1910	1223	903	1477	150	937	135	765	650	280	50	100	4"	100	4"	65	2 1/2"	105	135	

1) Available in metric system; i.e., DIN 11851
 2) Available in inch system; i.e., Tri Clamp (ISO 2852)

All weights and dimensions are subject to change without notice.

